

## MODELS mPCIe-COM-4SM, mPCIe-COM-4S, mPCIe-COM232-4 AND mPCIe-COM-2SM, mPCIe-COM-2S, mPCIe-COM232-2

### FEATURES

- PCI EXPRESS MINI CARD (mPCIe) TYPE F1, WITH LATCHING I/O CONNECTORS
- FOUR AND TWO-PORT mPCIe SERIAL CARDS WITH OPTIONAL DB9M CONNECTIVITY
- FOUR SOFTWARE SELECTABLE SERIAL TYPES: RS-232, RS-422, AND RS-485 (2WIRE & 4WIRE)
- "SM" MODELS SUPPORT ALL 3 SERIAL TYPES. "S" MODELS SUPPORT RS-422 AND RS-485
- HIGH PERFORMANCE 16C950 CLASS UARTS WITH 128-BYTE FIFO FOR TX AND RX BUFFERING
- SUPPORTS DATA COMMUNICATION RATES TO 921.6KBPS IN RS232 – AS HIGH AS 3MBPS IN DIFFERENTIAL MODES – 16MHZ WITH CUSTOM CRYSTAL OPTION
- PORT-BY-PORT FIELD SELECTABLE TERMINATION FOR RS422 & RS485 APPLICATIONS
- VIRTUALLY ANY CUSTOM BAUD RATE MAY BE CONFIGURED BY THE USER VIA REGISTER SETTINGS, NO CUSTOM OSCILLATOR NEEDED
- ±15kV ESD PROTECTION ON ALL SIGNAL PINS
- SUPPORTS CTS, RTS, 9-BIT DATA MODE, HALF-DUPLEX AND FULL-DUPLEX COMMUNICATIONS
- ROHS AND INDUSTRIAL TEMP (-40°C TO 85°C) BOTH STANDARD



### FUNCTIONAL DESCRIPTION

The mPCIe-COM-4SM family of cards feature high performance 16C950-class UARTs. Available in 4-port and 2-port versions, each port is capable of communication speeds up to 921.6kbps in RS-232 (differential modes support speeds as high as 3Mbps) and has 128-byte deep transmit and receive FIFOs. Large FIFOs protect against data loss in multitasking operating systems, reduce CPU utilization, and improve data throughput, while reducing or eliminating inter-character or inter-packet pauses. The advanced integrated circuit with pre-scaler supports a wide variety of custom baud rates, and any rates not otherwise achievable can be supported via a custom factory-installed crystal oscillator (up to 16Mbps!).

RS-232, RS-422, or RS-485 can be software selected, per port, and the selection is stored in non-volatile memory for future use. If you don't need that much flexibility you can order versions with only RS422/485 or even pure RS232. The RS232 ports provided by the card are 100% compatible with every other industry-standard serial COM device, supporting TX, RX, RTS, and CTS. RS422 mode uses the same transceivers as the RS-485 specification, allowing perfect 4-wire RS-422 and RS-485 compatibility – and the device supports full-duplex RS-485 4-wire.

Communication is possible either with custom application software, with off-the-shelf applications (such as HyperTerminal), or with provided samples and utilities, including WinRISC™ ("Windows Really Incredibly Simple Communication").

The serial ports on the device are accessed using a low-profile, latching, 6-pin Hirose connector. Optional breakout cables are available, and bring each port connection to a panel-mountable DB9-M connector.

### SPECIAL ORDER

Please contact ACCES with your precise requirement. Examples of special orders would be custom oscillators, conformal coating, custom software or product labelling, and more. We will work with you to provide *exactly* what is required.

### ACCESSORIES

Available accessories include:

CAB-mPCIe-COM2	Two port DB-9 cable accessory kit
CAB-mPCIe-COM4	Four port DB-9 cable accessory kit
ADAP-9	DB-9 Screw Terminal Accessory
mPCIe-HDW-KIT2	2mm mounting hardware
mPCIe-HDW-KIT2.5	2.5mm mounting hardware

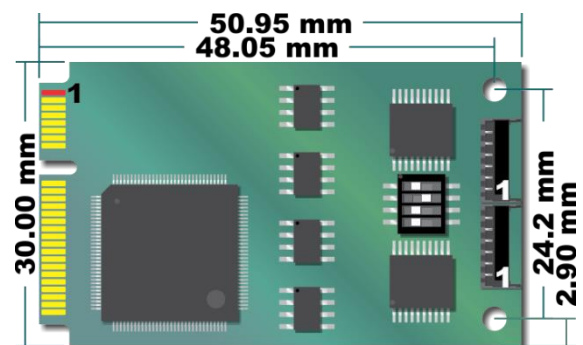

### SOFTWARE

A complete driver support package is provided including an easy-to-use Windows terminal program for testing your COM ports. This simplifies the verification of proper COM port operation. The card installs as standard COM ports in all operating systems including DOS, Linux (including Mac OS X) and 32-bit and 64-bit Windows. Additional drivers may be available for a wide variety of operating systems including Windows CE, please contact the factory for compatibility with your specific OS.

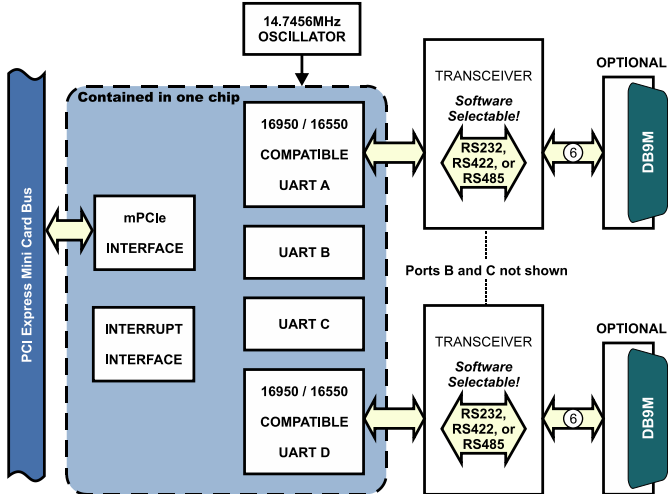

## PC Interface

PCI Express Mini Card Type F1 "Full Length" V1.2

## Communications Interface

Connector	I/O Hirose DF57-6P-1.2V 6-pin, latching
	Mating Hirose DF57H-6S-1.2C
Serial Ports	4 (or 2)
software selected serial type	-4SM (-2SM) RS-422, RS-485, and RS-232
(per port, stored in EEPROM)	-4S (-2S) RS-422 and RS-485
	232-4 (232-2) RS-232 only
UART	Quad 16C950
	FIFO 128-byte transmit & receive
Baud Rates	up to 921.6k baud in RS-232 up to 3MBaud in differential modes advanced-prescaler allows a wide variety of unusual baud rates to be achieved. Up to 16Mbps via custom crystal option
Character length	5, 6, 7, 8 bits (contact factory for assistance with 9-bit data)
Parity	Even, Odd, None, Mark, Space
Stop Interval	1, 1½, 2 bits
Flow Control	RS-232 RTS/CTS, Xon/Xoff, None
	RS-422, RS-485 Xon / Xoff, None

## Environmental

Temperature	Operating	-40° to 85°C
	Storage	-65° to 150°C
Humidity	5% to 95%, non-condensing	
Power required	+3.3VDC @ 1.6W (typical)	
ESD Protection	±15kV on all signal pins (IEC 61000)	

### Mating

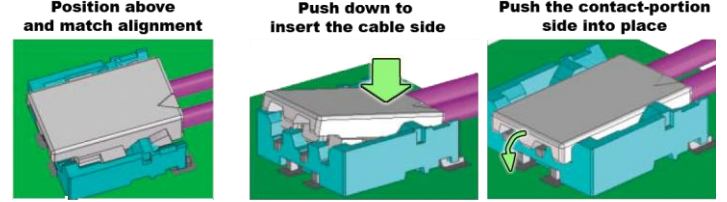

### Un-Mating

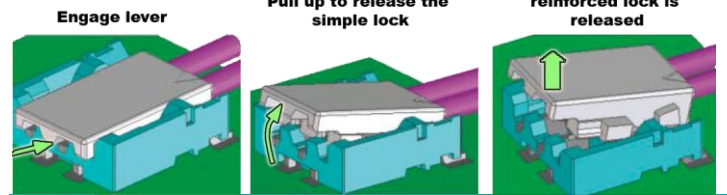

## Physical

Weight	6.4 grams
Size	Length 50.95mm (2.006")
	Width 30.00mm (1.181")

DB-9 Male Pin	232	422	485
1		Tx-	
2	RX	Tx+	
3	TX	Rx+	Rx/Tx+
4	RTS <sup>1</sup>	Rx-	Rx/Tx-
5	GND	GND	GND
6			
7	RTS	Rx <sup>-1</sup>	
8	CTS		
9			

**Note 1: pin 4 and pin 7 are connected.**

Hirose 6-pin	232	422	485
1	GND	GND	GND
2	Tx	Rx+	Rx/Tx+
3	Rx	Tx+	
4	RTS	Rx-	Rx/Tx-
5	CTS		
6		Tx-	

Signal Definitions	
Signal	Meaning
	no connect
RX	Receive Data
TX	Transmit Data
GND	Signal Ground
RTS	Request To Send
CTS	Clear To Send
Tx-	Diff. full-duplex TX -
Tx+	Diff. full-duplex TX+
Rx+	Diff. full-duplex Rx+
Rx-	Diff. full-duplex Rx-
Rx/Tx+	Diff. half-duplex +
Rx/Tx-	Diff. half-duplex -
Rx- RTS	Pin 4 and pin 7 are connected, so these signals are duplicates to be ignored.

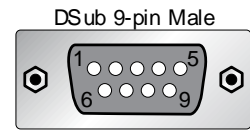

## ORDERING GUIDE

mPCIe-COM-4SM	4-port, RS-232, -422, and -485 PCI Express Mini Card
mPCIe-COM-2SM	2-port, RS-232, -422, and -485 PCI Express Mini Card
mPCIe-COM-4S	4-port, RS-422, and -485 PCI Express Mini Card
mPCIe-COM-2S	2-port, RS-422, and -485 PCI Express Mini Card
mPCIe-COM232-4	4-port RS-232 PCI Express Mini Card
mPCIe-COM232-2	2-port RS-232 PCI Express Mini Card

*SHIPS STANDARD WITH INDUSTRIAL OPERATING TEMPERATURE AND ROHS*